

9204 Washington Rd., Mplwd.

⁸⁴⁰⁰⁰
~~\$5,000~~ Lot

Replacing active M.L.#8338

F & C

Located @ corner of Washington Rd. & Lafayette Circle, Washington Park

Lot 80 x 100 approximately

Listed - Jan. 11, '35. In force until cancelled.

L.B. - Oakes Brokerage Co., SO 2-2080

Assoc. Bldr. Member - Salmon Realty Co., 417

Valley St., S. Orange, phone SO 2-1900. This

is one of the few lots left in this section.

16'

OK
8/11/38

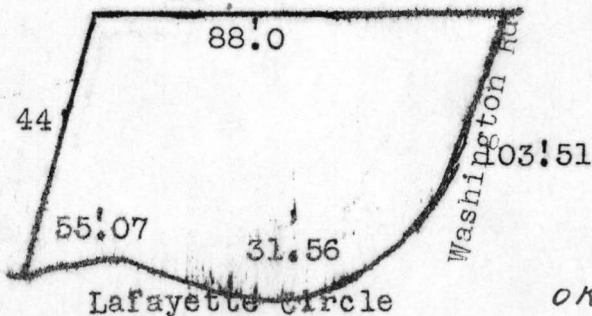

(over)

OK letter 5/20/38

Washington Rd., Maplewood

Lot

~~\$5,000~~

7/31/40 - Letter - Price reduction to \$4,000.

#2067-7/8/40

#2780 10/6/45 Withdraw from the market. (Ass. Bldr. listing)



7324

7224

Washington Road Maplewood

\$6,000 lot

Reversed indefinitely - B1323 - 9/24/32

Located at the corner of Washington Road and Lafayette Circle. Washington Park.

Lot - 80 x 100 approx.

Listed September 22, 1931. Expires - March 22, 1932. B1289

L. B. - Oakes Brokerage Co., So. 2-2080.

Owner - Associate Builder Listing - Salmon Realty Co.,
417 Valley Street, South Orange, So. Or. 2-1900.

One of the few lots left in this section.

see
M.F.
833

N 17° 44' W

N. 48° 16' E

88.0

55.07

31.56

103.51

19 = 387.0

Washington Road

Lafayette Circle

A = 214.0

A = 25.0

Washington Road

Maplewood

Lot - \$6,000